

Installation Instructions

Alpha Premier Pack

(Part No. 3.017230)

For use with Alpha Condensing Boilers

CD25X, CD28X

CD12S, CD20S, CD28S

CD25C, CD28C, CD35C

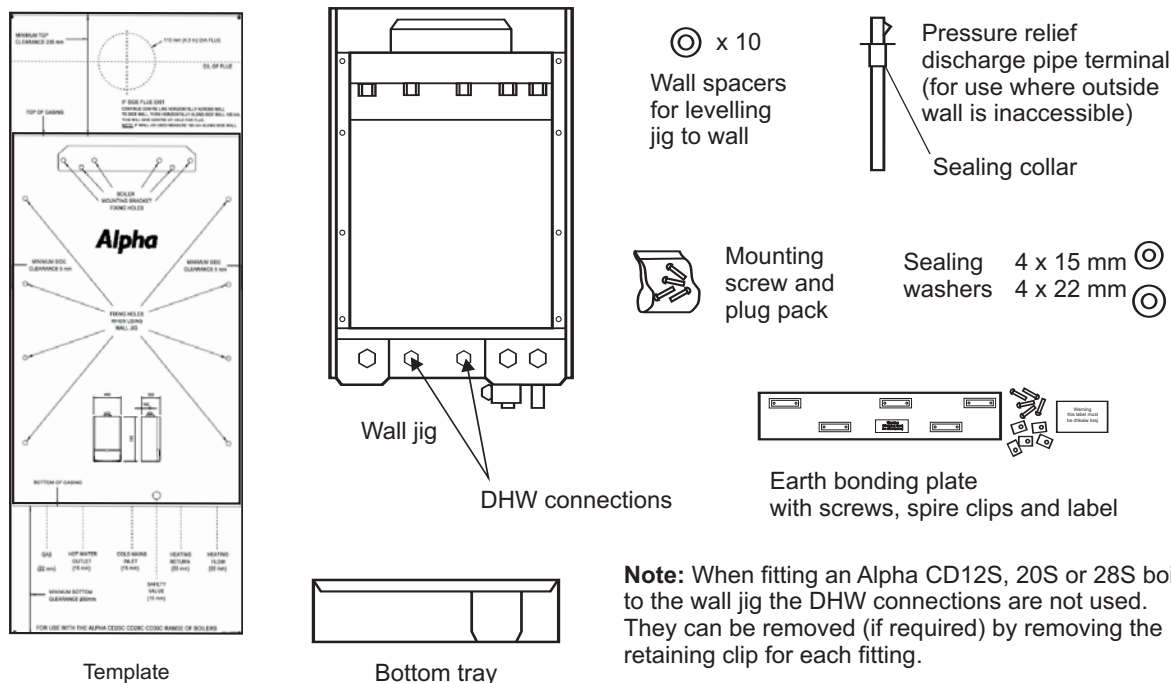

Fig. 1 Kit Contents

1. INTRODUCTION

The Alpha Premier Pack is only suitable for use with the above Alpha boilers and must be installed in accordance with these instructions and the installation instructions supplied with the boiler.

The kit comprises of a wall jig fitted with a cyclone and pipe clips, wall template, flow and return split tails, discharge pipe terminal, earth bonding plate, bottom tray, screw pack and wall spacers. The wall jig has been designed to be fitted to the wall before the boiler, allowing the pipework to be pre-fitted. The pipework can be installed vertically upwards and downwards using the flow and return connections supplied on the jig.

As the wall jig adds 40 mm to the depth of the boiler, clearances and flue measurements need to be adjusted accordingly.

2. INSTALLATION

a. Fit the Wall Jig - See Fig. 2

Tape the wall template to the wall in the required position, making sure it is level. Mark the positions of the eight fixing holes for the wall jig as shown on the template. Mark the flue position and also mark the position of the pressure relief valve pipe hole.

Out of the eight holes marked choose four that are suitable then drill the four holes using a 10 mm drill. Insert the wall plugs provided. If applicable, drill a 25 mm diameter hole for the pressure relief valve discharge pipe.

Using a 110 mm core drill cut the hole for the flue.

Note: If a vertical or side flue is to be used, ensure that 40 mm is added to the distance from the centre of the flue hole to the wall on which the boiler is to be mounted. This is to allow for the depth of the wall jig.

Secure the wall jig to the wall using the screws provided, ensuring it is level and flat against the wall. The wall spacers supplied may be placed between the wall and the jig if the wall is not flat.

Notes: 1. To ensure the boiler is fitted to the jig correctly, the jig must be flat against the wall and the boiler flat against the jig.
2. Ensure the front faces of sides A and B of the jig are vertical.

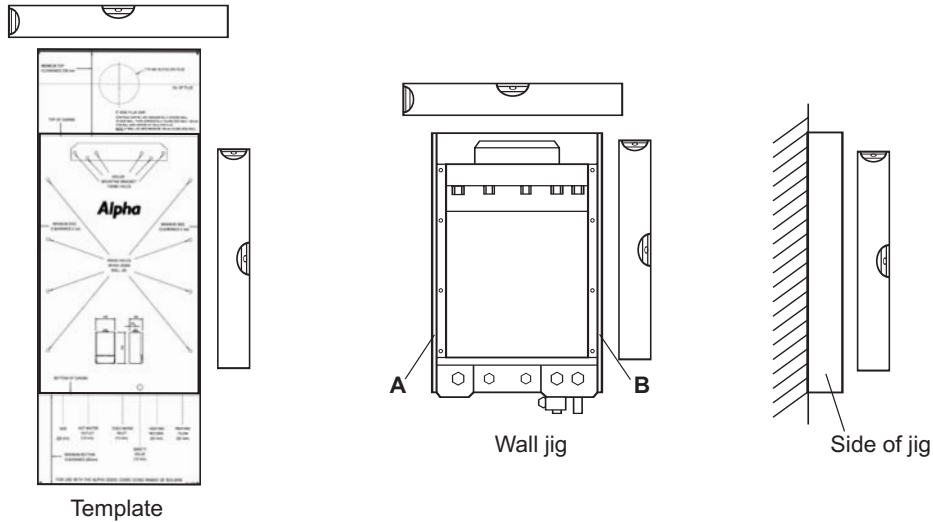

Fig. 2

b. Water Connections - See Fig. 3

Remove all the union bends from the boiler and connect the gas, DHW and cold mains inlet bends to the jig. Remove the pressure relief valve discharge pipe from the boiler.

Connect the pipework to the jig using the gas, domestic hot water and cold mains inlet union bends supplied with the boiler and the flow and return unions supplied with the wall jig. The use of the flow and return unions supplied with the jig allows the system pipework to be routed downwards or upwards at the rear of the boiler.

Clips are provided on the jig for securing the pipework at the rear of the boiler.

Notes: 1. When soldering to the union bends, ensure that the bends are not connected to the valves, jig, etc. otherwise damage may be caused.

2. The return union bend supplied with the jig cannot be rotated, therefore if only routing at the rear, the downward connection will need to be blanked off.

Thoroughly flush all water pipework as described in the instructions supplied with the boiler.

Note: Disconnect the filling loop after filling the central heating system.

- A - Heating flow (22 mm)
- B - Hot water outlet (15 mm)
- C - Gas inlet (22 mm)
- D - Cold water mains inlet (15 mm)
- E - Heating return (22 mm)
- F - Pressure relief valve (15 mm)
- G - Heating drain point
- H - Cold water inlet filter
- I - Cyclone
- K - Wall jig

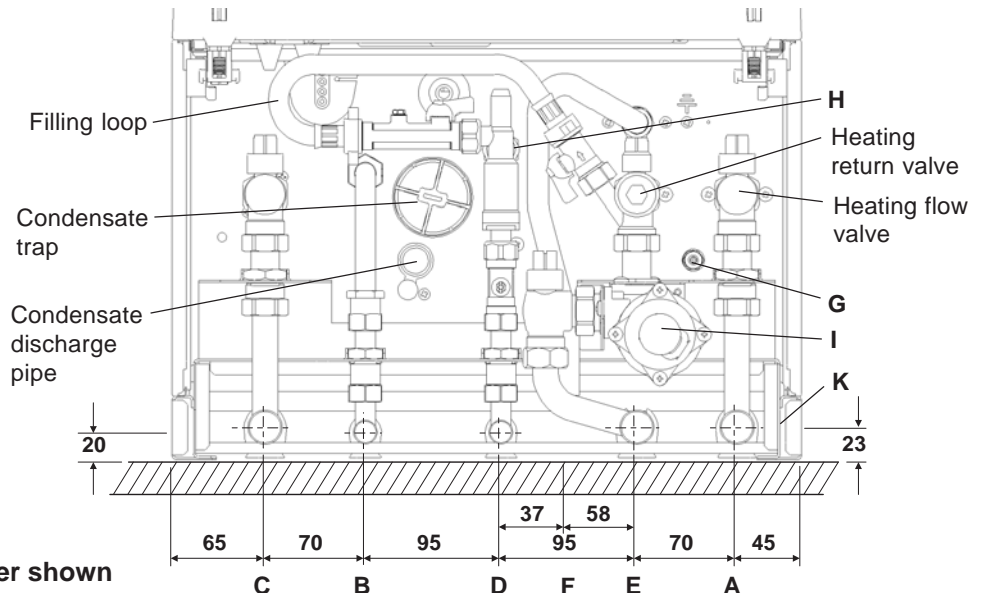

Fig. 3 - Alpha CD C boiler shown

c. Earth Bonding Plate Installation - See Fig. 4

The earth bonding plate can be installed on the vertical pipes within the wall jig or to pipes above or below the boiler.

Slide the earth bonding plate behind the connecting pipes and bend the tags around the pipes until they meet at the front. Using the screws and spire clips provided, secure the tags together ensuring they pull tight against each pipe. Ensure that the pipes are clean before securing the tags.

Note: With reference to BS7671, the earth bonding plate supplied meets the requirements for supplementary equipotential bonding in the locality of the boiler.

Fit the label supplied in a location on the boiler or pipework where it can be seen.

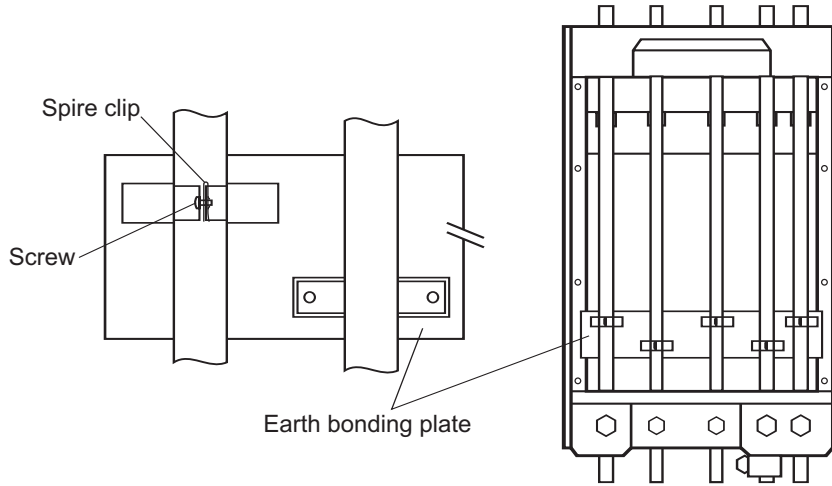

Fig. 4

d. Pressure Relief Valve Discharge Pipe Terminal Installation (if applicable) - See Fig. 5

Note: For use when the boiler is mounted on an external wall where the outside is inaccessible.

Push the wall sealing collar, supplied, onto the discharge pipe terminal so that the terminal protrudes as shown in Fig. 5.

Note: Using tape to secure the collar to the pipe will assist in ensuring the position of the collar is maintained.

Insert the pressure relief pipe terminal through the hole previously drilled until the wall sealing collar has passed through the wall to the outside. Pull the pipe back so that the sealing collar is pressing against the outside wall.

Cut the pipe so that it protrudes 45 mm inside the property. This should now butt up to relief valve discharge pipe on the boiler when it is fitted. Connect the pipes together using a straight connector and make good the inside wall.

Note: The pressure relief valve discharge pipe must be routed and terminated in such a manner that it may be seen, but cannot cause injury to persons or damage property.

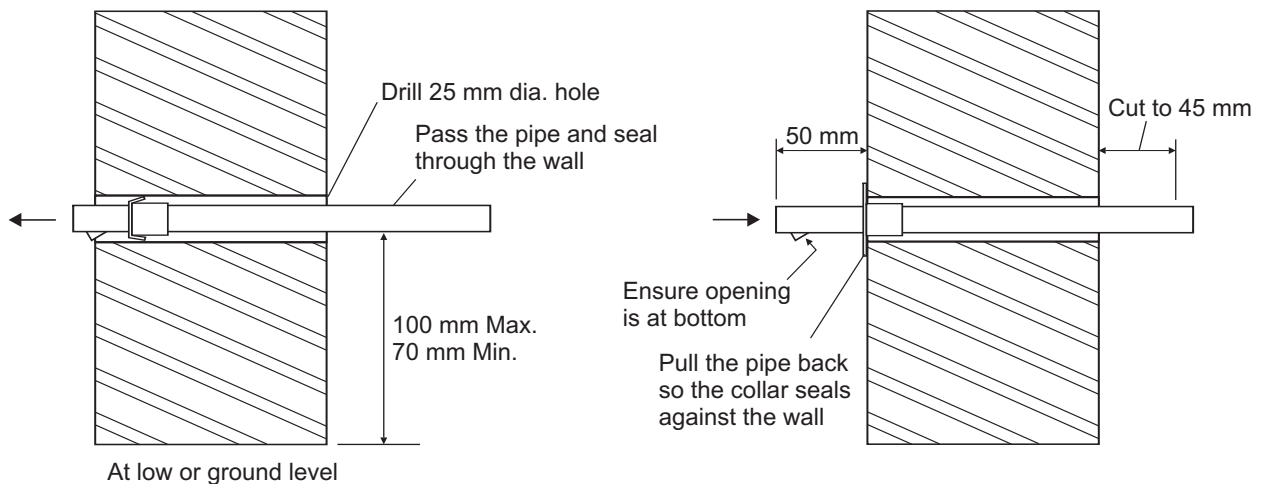

Fig. 5

e. Fit the Boiler to the Jig - See Fig. 6

Lift the boiler and lower it onto the bracket at the top of the jig, whilst keeping the bottom of the boiler held away from the jig. This will prevent the boiler valves catching the union nuts on the wall jig. When the boiler is located on the top bracket, let it rest against the union fittings at the bottom. Insert the washers provided between each union connection and tighten the joints.

Refit the pressure relief valve discharge pipe.

Note: The valves/fittings on the boiler have been factory fitted, however check all connections underneath the boiler have been tightened, especially the union bends.

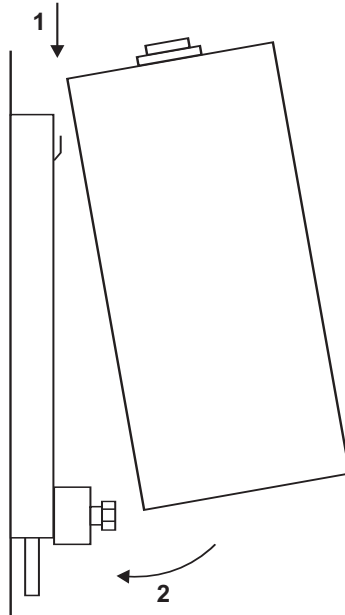

Fig. 6

- f. Connect the flue, connect the electrical supply, fill the boiler and commission the system as described in the instructions supplied with the boiler.
- g. Fit the bottom tray by pushing it into position underneath the boiler.

Alpha
HEATING INNOVATION

Alpha Therm Limited.
Nepicar House, London Road, Wrotham Heath,
Sevenoaks, Kent TN15 7RS
Tel: 0870 3001964
email: info@alphatherm.co.uk
website: www.alpha-innovation.co.uk

*These instructions have been carefully prepared but we reserve the right to alter the specification at any time in the interest of product improvement.
© Alpha Therm Limited 2008.*